

Exterior

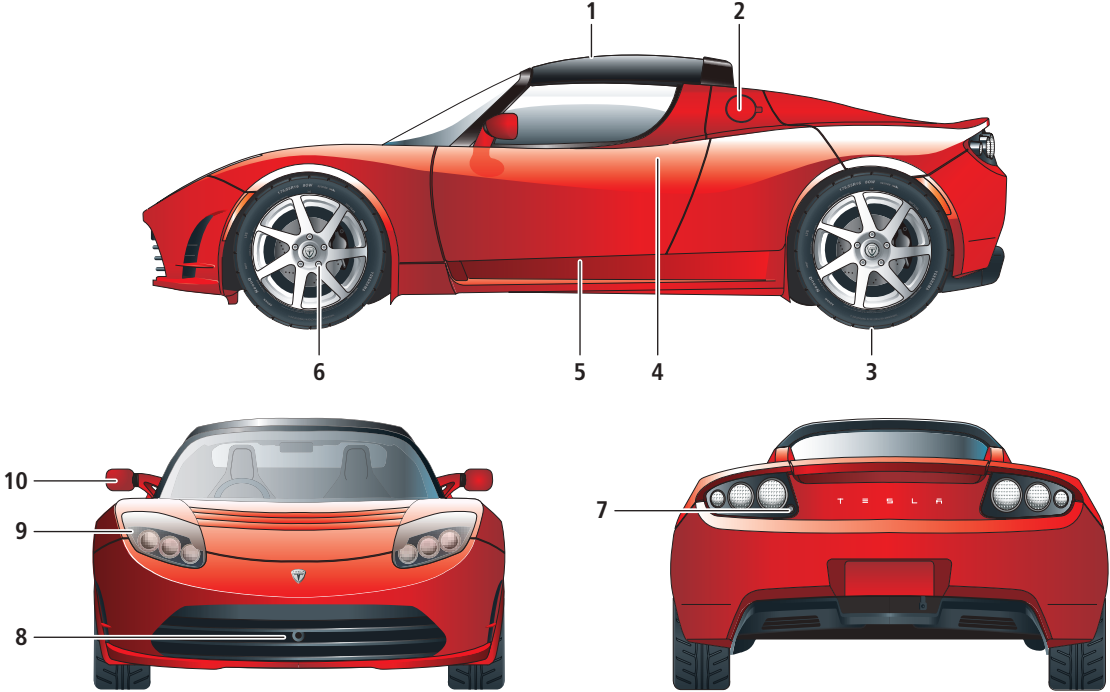

TR1487

Exterior overview

1. Roof. See Removable roof, page 7-9.
2. Charging port door. See Charging instructions, page 5-9.
3. Wheels and tires. See Wheels and tyres, page 10-6.
4. Exterior door release. See Exterior door release, page 4-4.
5. Emergency door unlock. See Emergency unlocking, page 4-5.
6. Wheel bolts. See Removing the wheel, page 9-6.
7. Trunk lock. See Opening the trunk, page 4-6.
8. Vehicle recovery eye. See Attaching the recovery eye, page 9-14.
9. Headlights. See Exterior lights, page 6-8.
10. Exterior mirrors. See Exterior rear view mirrors, page 7-3.

Interior

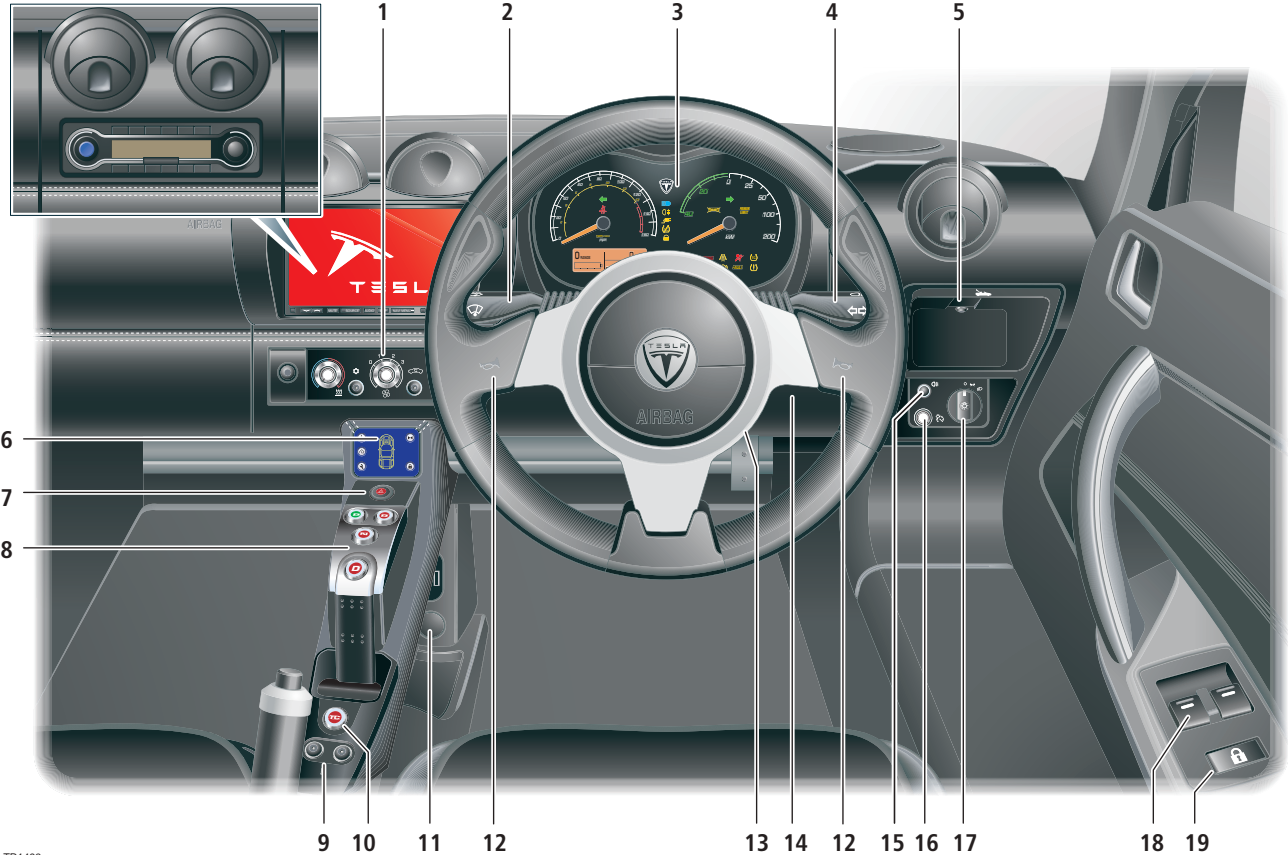

TR1493

Dashboard overview

1. Heating and air conditioning. See Interior temperature control, page 7-4.
2. Turn signals, headlight high beam and cruise control. See Exterior lights, page 6-8 and Cruise control, page 6-11.
3. Instruments. See Instruments, page 6-12.
4. Windshield wiper and washer. See Windshield wiper and washer, page 6-10.
5. Trunk release. See Opening the trunk, page 4-6.
6. Touch Screen. See 'Touch Screen User's Manual'.
7. Hazard warning light switch. See Hazard warning, page 6-9.
8. Gear selector. See Selecting gears, page 6-5.
9. Seat heaters. See Seat heaters, page 7-6.
10. Traction control switch. See Traction control, page 6-7.
11. Accessory power socket. See Accessory power socket, page 7-7.
12. Horn. See Horn, page 6-9.
13. Starter switch. See Starting the vehicle, page 6-2.
14. Bonnet release. See Opening and closing the bonnet, page 8-3.
15. Rear fog lamp. See Rear fog light, page 6-9.
16. Instrument panel illumination control. See Instrument panel lighting, page 6-15.
17. Exterior lights master switch. See Exterior lights, page 6-8.
18. Power windows. See Operating the windows, page 7-2.
19. Central door locking. See Central door locking, page 4-4.

Seating and safety restraints

Seats

Seat adjustment 3-2

Seat belts

General information 3-3

Seat belt safety instructions 3-3

Seat belt reminder 3-3

Using the seat belts 3-4

Wearing seat belts during pregnancy 3-4

Seat belt tensioners 3-4

Caring for seat belts 3-5

Child seats and restraints 3-5

Airbag system

General information 3-6

How the system works 3-6

Obstruction of airbags 3-6

Deployment effects 3-7

Airbag warning indicator 3-7

Passenger airbag deactivation 3-7

Airbag warning labels 3-7

Using child seats 3-7

Airbag service information 3-8

Vehicle modifications 3-8

Seats

Seat adjustment

⚠ WARNING: Never adjust the driver's seat while your vehicle is moving. Unexpected or sudden seat movement could result in an accident. ▲

Driver's seat position

To adjust the forward/rearward position of the driver's seat, raise the bar beneath the front of the seat and slide the seat to the required position. Release the bar to lock the seat into position. Ensure that the seat is locked in position before driving, by trying to slide the seat forward.

To reduce the risk of injury in the event of an accident, Tesla recommends the following when adjusting seat position:

- Adjust the seat so that you can press the foot pedals fully to the floor with your knees slightly bent.
- Make sure that you can comfortably reach the top of the steering wheel.
- Ideally a minimum distance of 254 mm (10 inches) is recommended between the steering wheel cover and your breastbone.
- Fasten your seat belt correctly.

Head restraints

Each seat is provided with a head restraint. The head restraints are integral with the seats and therefore can not be adjusted or removed.

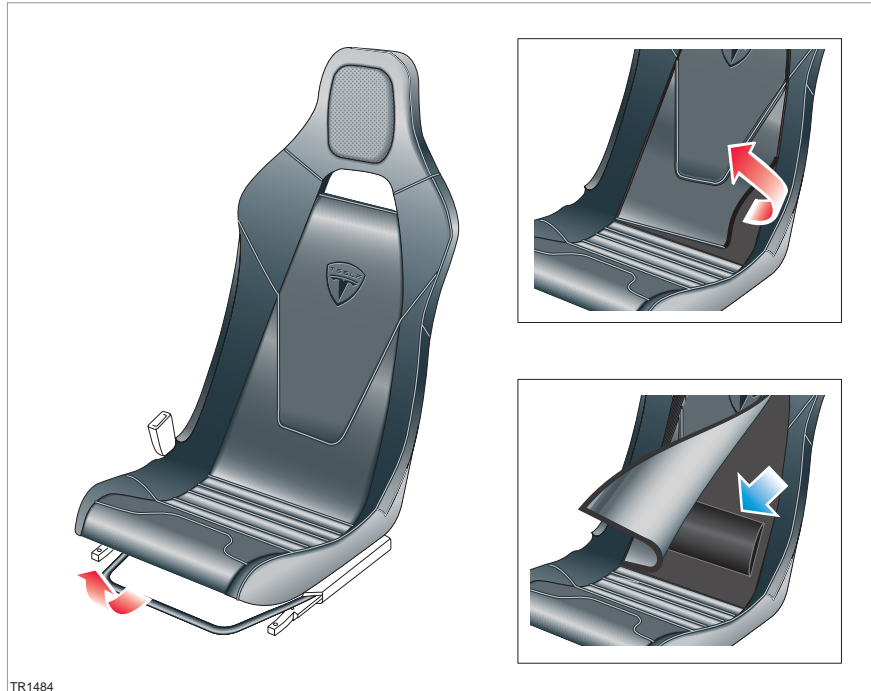

Lumbar support

Lumbar support is provided using a pad inserted under the seat cushion.

To adjust lumbar support, the position of the pad can be moved or additional lumbar support pads can be added. Lumbar support pads are available from Tesla Motors.

To access the lumbar support pad, carefully pull the lower edge of the seat covering towards you. Move the existing pad as required or install an additional one.

Once complete, push the seat cover back into place.